

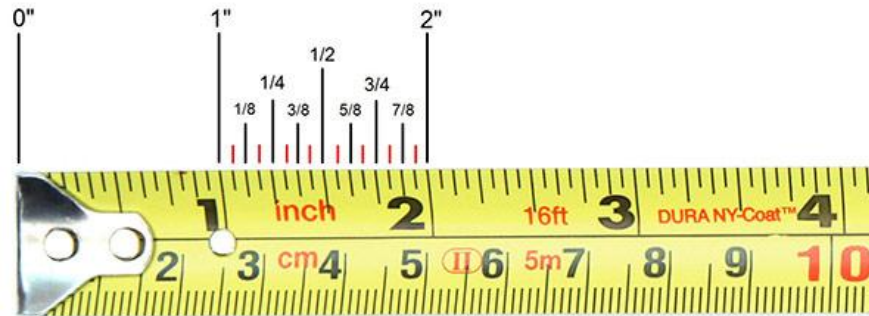

Measuring Guide

How to Read your Measuring Tape



For the purposes of measuring your kitchen or room for ClearView Kitchens, please note that you will be using **inches** or **imperial** measurements.

Imperial Measurements

On your measuring tape, (see diagram above for your reference) you'll see a series of large numbers marked 1, 2, 3, and 4. These numbers sit next to long vertical marks which represent whole inches. Put simply 1 = 1", 2 = 2" and so on.

Between those numbers are a series of shorter marks which represent fractions of an inch. The mark directly in the middle of the inch denotes a measurement of 1/2". The markings directly in the middle of each of the 1/2" mark represent measurements of 1/4" and 3/4" respectively. Even smaller marks then denote 1/8ths and 1/16ths (marked in red in the diagram) of an inch.

For measuring your kitchen or any other room, you will be **rounding off to the nearest 8th of an inch**.

Taking a Measurement

When using a retractable tape measure, you'll have a small metal hook at the end of the tape. Use it to grab onto the edge of what you are measuring to hold the blade in place.

If you aren't measuring something you can latch onto – the distance across a door frame, for example – press the hook against one side to ensure an accurate reading.

With the hook pressed in place, pull the tape blade out until it spans the distance you're measuring. Keep the tape straight as much as possible. If it sags, your measurement will be off. It will be better to measure the room with two people.

Once you've gotten the tape where you need it to be, take the measurement directly from the tape.

Measuring your Kitchen or Room

Below is a step-by-step guide to measuring your space. Please read everything carefully to ensure that we receive the correct information to build your new kitchen or other cabinetry. Remember, **be thorough when measuring** and give yourself plenty of time to measure precisely.

Supplies you will need:

- 25' Retractable Steel Tape Measure
- Pencil or other writing utensil
- Notepad
- Small Step Ladder (if possible)

Step 1: Draw A Floor Plan

To carefully configure the dimensions of your kitchen or other space, start with a floor plan. Determine the shape of your kitchen by referencing Figures 1-6 below. Sketch your kitchen layout using grid paper found on page 7. Be sure to mark the locations of any doors and windows.

Be sure to label your walls and make sure to measure in a clockwise direction. Once you determine your kitchen shape, measure according to the wall labels in blue below.

Kitchens Shapes

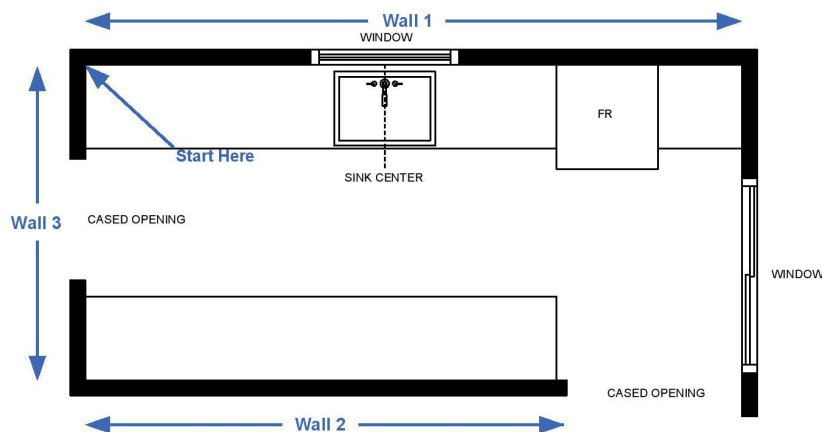

Figure 1 - "Galley Kitchen"

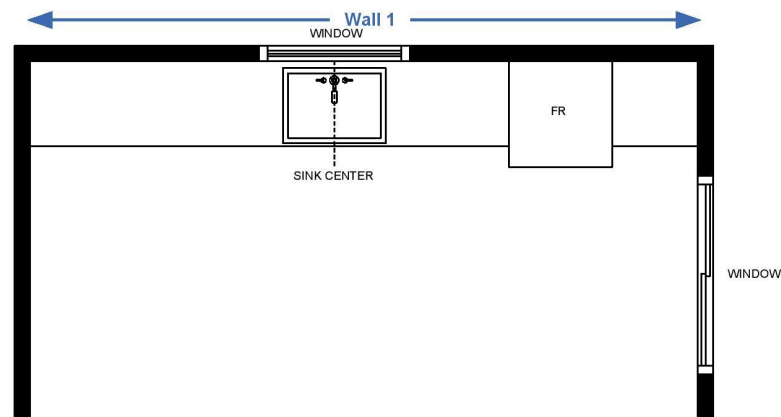

Figure 2 - "Linear Kitchen"

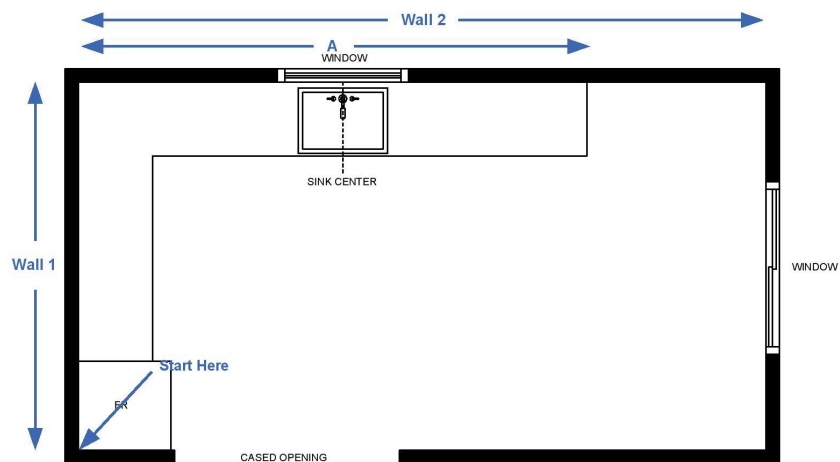

Figure 3 - "L-Shaped Kitchen". Note: If you know the exact location you want the cabinets to stop on the longest wall, please indicate that measurement (Measurement "A").

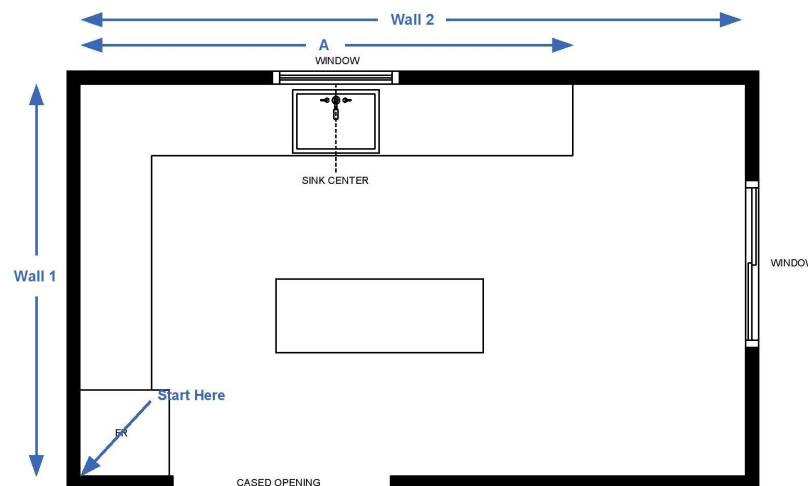

Figure 4 - "L-Shaped Kitchen with island". Note: If you know the exact location you want the cabinets to stop on the longest wall, please indicate that measurement (Measurement "A").

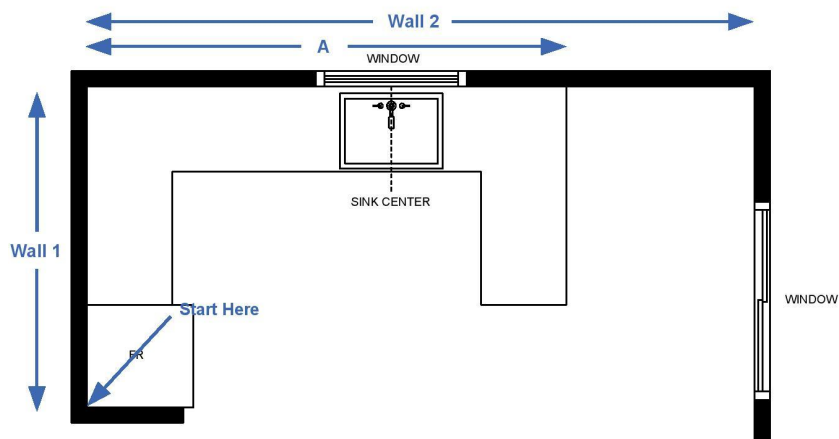

Figure 5 - "L-Shaped Kitchen with peninsula". Note: If you know the exact location you want the peninsula placed on the longest wall, please indicate that measurement (Measurement "A").

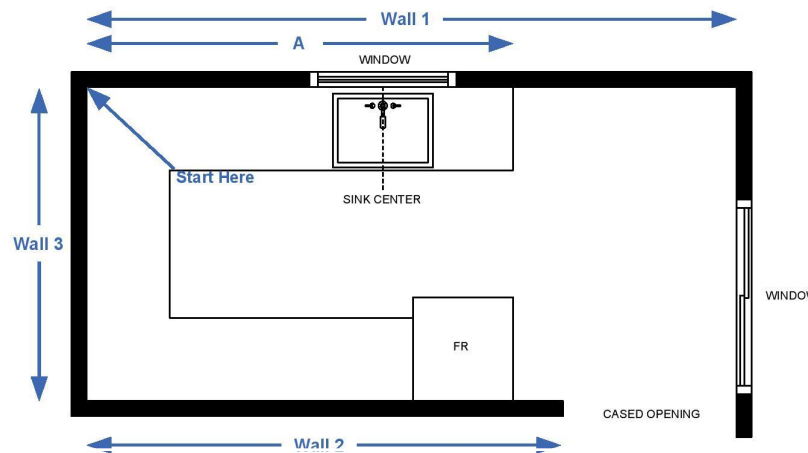

Figure 6 - U-Shaped Kitchen with island. Note: If you know the exact location you want the cabinets to stop on the longest wall, please indicate that measurement (Measurement "A").

Step 2: Horizontal Measurements

Start from an adjoining corner of the wall and work clockwise, taking horizontal measurements of the wall. Measure from one edge of the wall to the other, skipping over any windows, appliances, or fixtures. See “Figure 7” for your reference.

After you’ve recorded the entire wall lengths, measure and record the wall in smaller segments, such as from a corner of the wall to the outside trim of a wall opening or obstacle. **Any trim or molding around it should be part of the measurement.**

Tip: Be sure to double check the measurements when you’re done to ensure accuracy.

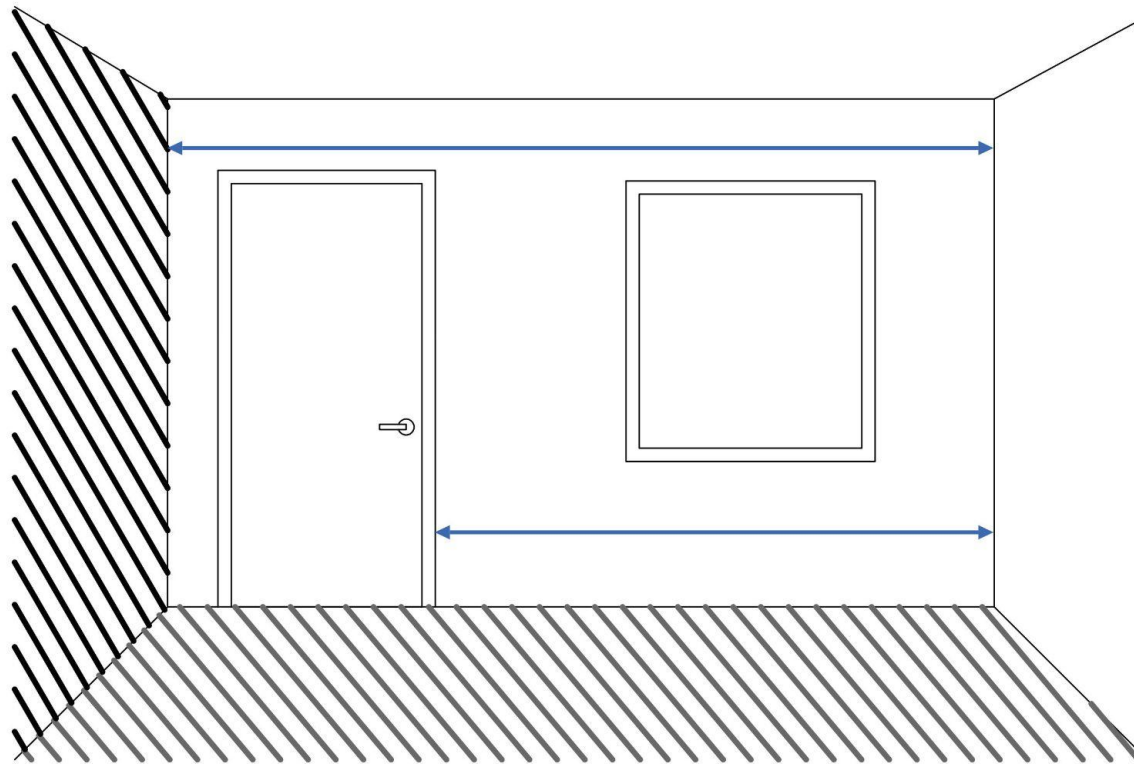

Figure 7- Horizontal measurements

Step 3: Vertical Measurements

Record vertical measurements from floor to ceiling. See “Figure 8” for your reference.

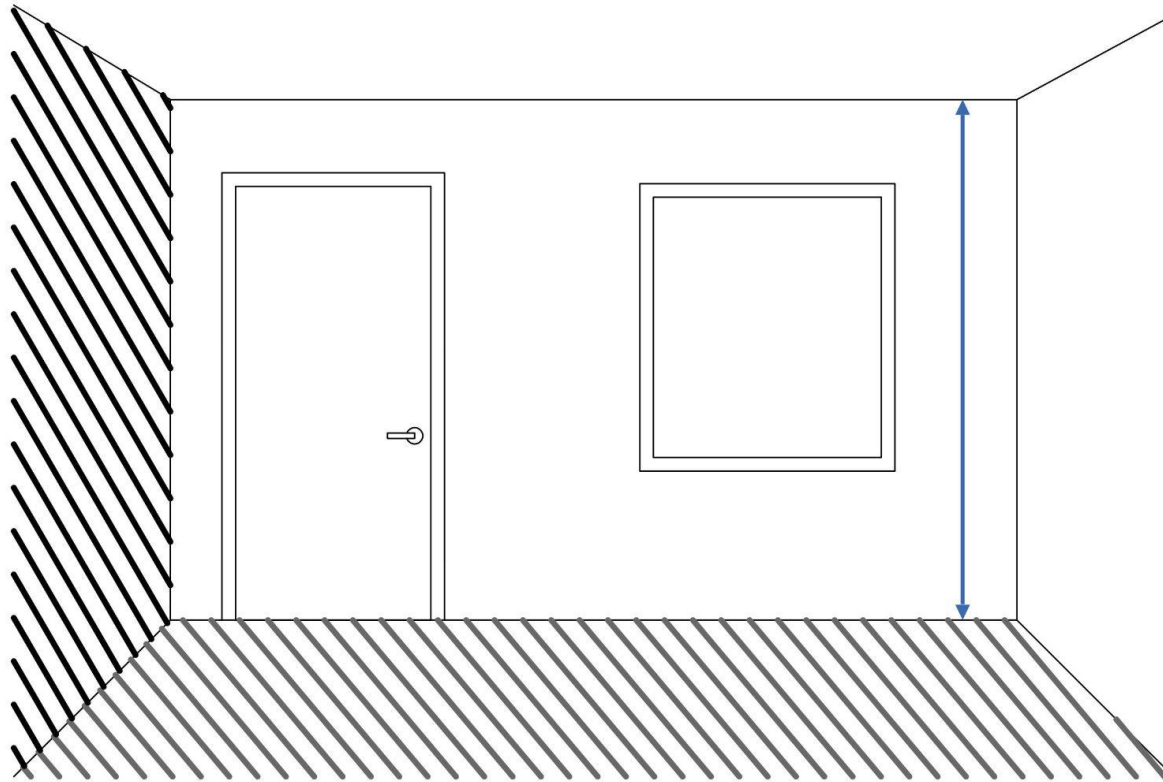
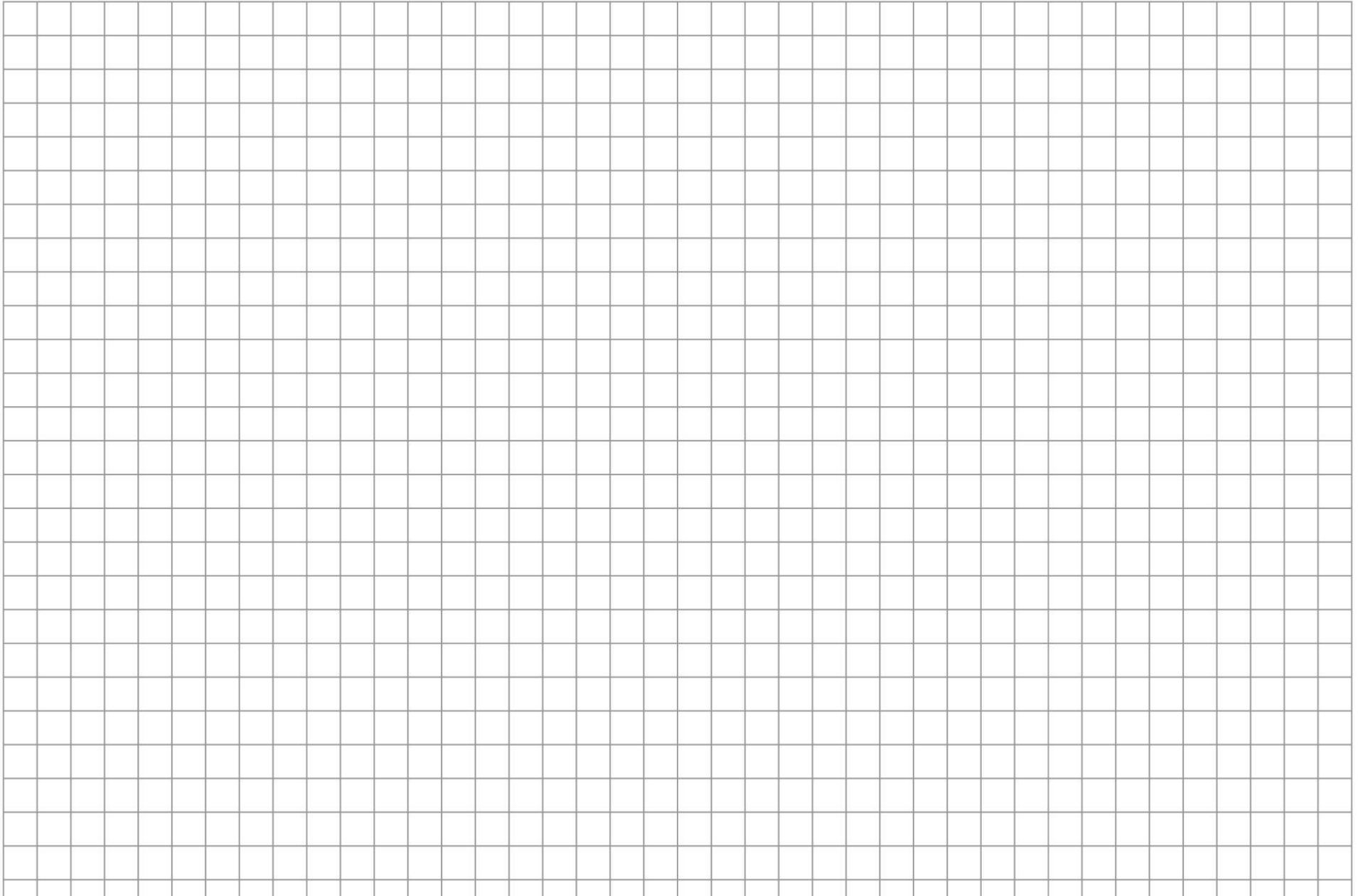

Figure 8 - Vertical measurements

CLEARVIEW
KITCHENS | HOMES

Kitchen Ceiling Height in Inches:_____



A large grid of graph paper, consisting of 20 columns and 20 rows of squares, intended for drawing and measuring.

CLEARVIEW
KITCHENS | HOMES

This image shows a full page of blank, lined paper. It features approximately 20 evenly spaced horizontal grey lines across the entire width of the page, typical of notebook or legal stationery. The background is a solid off-white color. There are no margins, text, or other markings present.